

# CONNECTOR MANUFACTURERS

**TOPTEK®**  
HARDWARE ELECTRONIC MANUFACTURER

www.toptek-co.com

Ø 19 mm

## P-TOP-19B-4-J



Diameter: Ø 19mm  
Switch Rating: 5A/250VAC  
Contact Configuration: 1NO  
Operation Type: Momentary  
The Front Shape: High  
The Crust Material:  

- Stainless steel
- Copper plating

 IP Degree: IP67, IK10

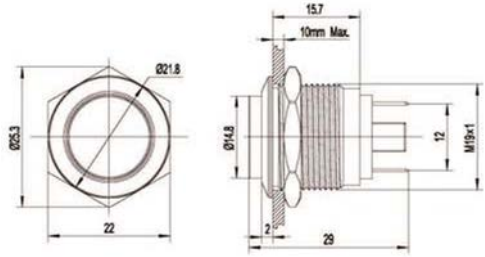

## C-TOP-19F-11L-S



Diameter: Ø 19mm  
Switch Rating: 5A/250VAC  
Contact Configuration: 1NO 1NC/  
2NO 2NC  
Operation Type:  

- Momentary
- Maintained (Z)

 The Front Shape: Flat  
The Crust Material: Stainless steel  
IP Degree: IP67, IK10

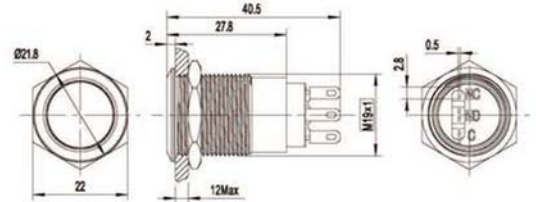

## C-TOP-19B-11L-S



Diameter: Ø 19mm  
Switch Rating: 5A/250VAC  
Contact Configuration: 1NO 1NC/  
2NO 2NC  
Operation Type:  

- Momentary
- Maintained (Z)

 The Front Shape: Ball  
The Crust Material: Stainless steel  
IP Degree: IP67, IK10

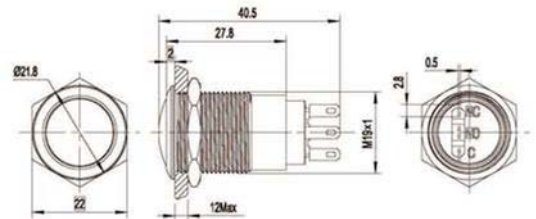

## C-TOP-19H-11L-S



Diameter: Ø 19mm  
Switch Rating: 5A/250VAC  
Contact Configuration: 1NO 1NC/  
2NO 2NC  
Operation Type:  

- Momentary
- Maintained (Z)

 The Front Shape: High  
The Crust Material: Stainless steel  
IP Degree: IP67, IK10

